

ROSEVILLE
REQUEST FOR COUNCIL ACTION

Date: 6-29-09
Item No.: 12.f

Department Approval

City Manager Approval



Item Description: **Community Development Department Request to Perform a City Abatement for Unresolved Violation of City Code at 2240 St. Stephen Street**

1 **BACKGROUND**

- 2 • The subject property is a single family home.
- 3 • The current owner is listed as Daniel and Deborah Thompson.
- 4 • Notice was sent April 28, 2009, requesting violations be corrected.
- 5 • Current violation include:
 - 6
 - 7 • A large amount of junk/debris, household items, and lumber in the side and rear yards (a
 - 8 violation of City Code Section 407.02.D and 407.03.H).
 - 9 • Building elements in disrepair, including – garage doors and siding, fencing and windows (a
 - 10 violation of City Code Section 906.05.C).
- 11 • A status update, including pictures, will be provided at the public hearing.

12 **POLICY OBJECTIVE**

13 The City goals within the Comprehensive Plan are to protect and improve property values (Goal 3, 4,
14 and 5; page 6 and, Section 3) and to adhere to performance standards which protect the integrity of the
15 housing units and the neighborhood (Policy 6, page 8, Section 3).

16 **FINANCIAL IMPACTS**

17 City Abatement:

18 An abatement would encompass the following:

- 19 • Disposal of junk/debris:
 - 20 ○ Approximately - \$700.00
- 21 • Repairs to house, garage, pool and fence:
 - 22 ○ Approximately - \$7,000.00
- 23 • Total: Approximately - \$7,700.00.

24 In the short term, costs of the abatement will be paid out of the HRA budget, which has allocated
25 \$100,000 for abatement activities. The property owner will then be billed for actual and administrative

26 costs. If charges are not paid, staff is to recover costs as specified in Section 407.07B. Costs will be
27 reported to Council following the abatement.

28 **STAFF RECOMMENDATION**

29 Staff recommends that the Council direct Community Development staff to abate the above referenced
30 public nuisance violations at 2240 St. Stephen Street.

31 **REQUESTED COUNCIL ACTION**

32 Direct Community Development staff to abate the above referenced public nuisance violation at 2240
33 St. Stephen Street by hiring a general contractor to repair the house, the garage, the pool and the fence.
34 The property owner will then be billed for actual and administrative costs. If charges are not paid, staff
35 is to recover costs as specified in Section 407.07B. Costs will be reported to Council following the
36 abatement.

37

Prepared by: Don Munson, Permit Coordinator

Attachments: A: Map of 2240 St. Stephen Street

2240 St. Stephen St

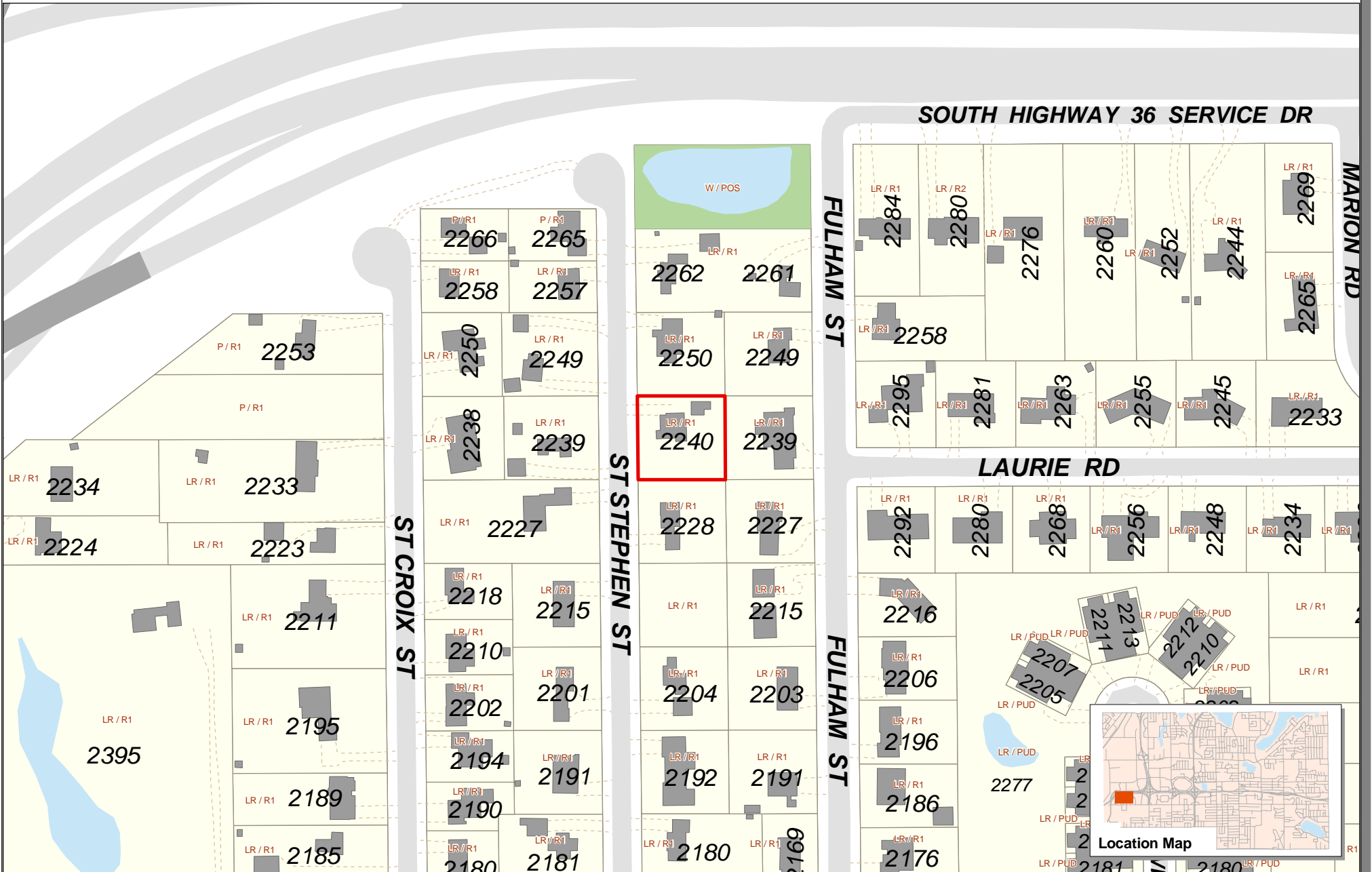

Prepared by:
 Community Development Department
 Printed: May 29, 2009



Site Location

LR/R1 Comp Plan / Zoning Designations

Data Sources

* Ramsey County GIS Base Map (5/14/2009)

For further information regarding the contents of this map contact:
 City of Roseville, Community Development Department,
 2660 Civic Center Drive, Roseville MN

Disclaimer

This map is neither a legally recorded map nor a survey and is not intended to be used as one. This map is a compilation of records, information and data located in various city, county, state and federal offices and other sources regarding the area shown, and is to be used for reference purposes only. The City does not warrant that the Geographic Information System (GIS) Data used to prepare this map are error free, and the City does not represent that the GIS Data can be used for navigational, tracking or any other purpose requiring exacting measurement of distance or direction or precision in the depiction of geographic features. If errors or discrepancies are found please contact 651-792-7085. The preceding disclaimer is provided pursuant to Minnesota Statutes §466.03, Subd. 21 (2000), and the user of this map acknowledges that the City shall not be liable for any damages, and expressly waives all claims, and agrees to defend, indemnify, and hold harmless the City from any and all claims brought by User, its employees or agents, or third parties which arise out of the user's access or use of data provided.

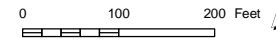
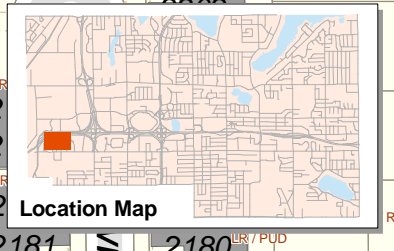

mapdoc: planning_commission_location.mxd